

BLD-A-S

Hollowed Load Cell

● Load Measurement ● 50 to 500 kN



To endure field applications, these transducers feature a waterproof design, and high accurately

The BLD-A-S series is compact and lightweight hollowed load cells designed to accurately measure the load applied to a PC anchor and rock bolt.

To endure field applications, these transducers feature a waterproof design and high accurately.

Specifications

Performance

Rated Capacity	See table below.
Nonlinearity	Within $\pm 1\%$ RO
Hysteresis	Within $\pm 1\%$ RO
Rated Output	1 mV/V or more

Environmental Characteristics

Safe Temperature	-20 to 70°C
Compensated Temperature	-10 to 60°C
Temperature Effect on Zero	Within $\pm 0.1\%$ RO/°C
Temperature Effect on Output	Within $\pm 0.1\%$ /°C

Electrical Characteristics

Safe Excitation	10 V AC or DC
Input Resistance	350 Ω $\pm 2\%$
Output Resistance	350 Ω $\pm 2\%$
Cable	4-conductor (0.5 mm ²) chloroprene shielded cable, 10 mm diameter by 1 m long, bared at the tip (Shield is not connected to the case.)

Mechanical Properties

Safe Overloads	120%
Weight	See table below.

Models	Rated Capacity	ϕA	ϕB	ϕC	H	Weight (Approx.)
BLD-A-50KNS	50 kN	10	22	50	60	200 g
BLD-A-100KNS	100 kN	20	32	61	80	300 g
BLD-A-200KNS	200 kN	20	42	61	80	600 g
BLD-A-500KNS	500 kN	25	54	64	100	1.3 kg

ϕA : Hollow diameter

Dimensions

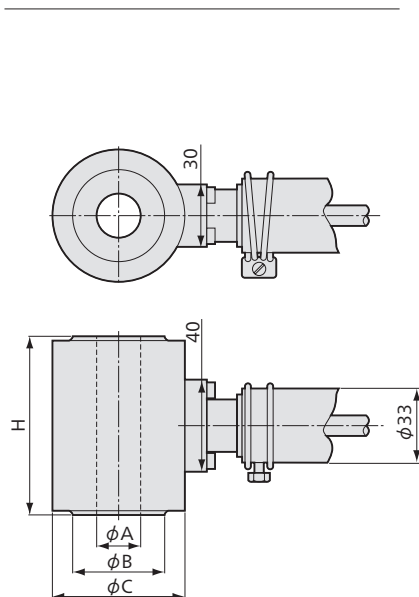

Application Example

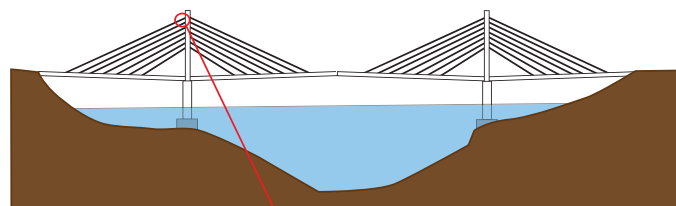

Tension measurement on anchoring cables of cable stayed bridge

